

# 8. FT7000 壓腳與相關零件 Presser Foot Components For Ft7000

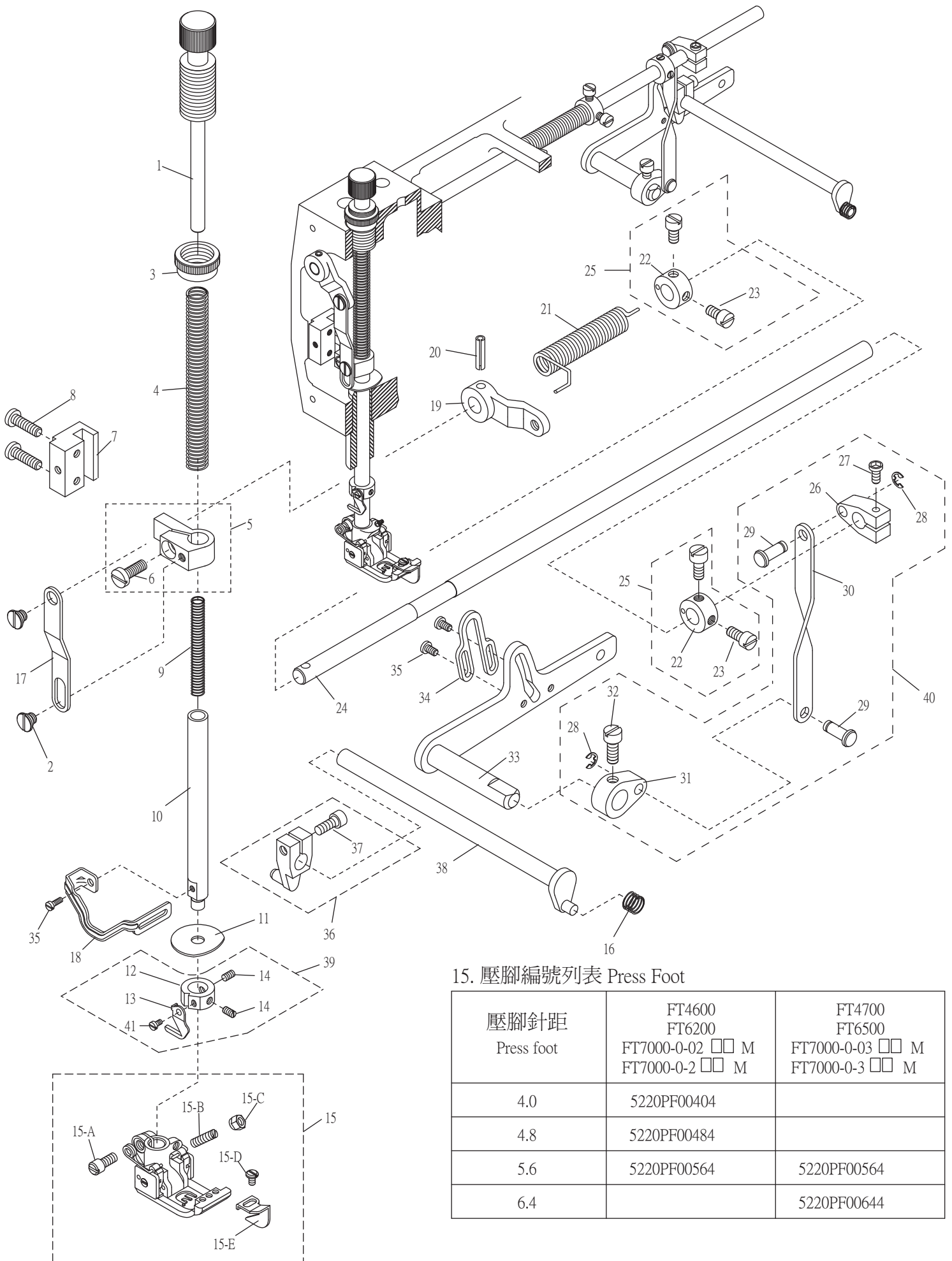

15. 壓腳編號列表 Press Foot

壓腳針距 Press foot	FT4600 FT6200 FT7000-0-02 □□ M FT7000-0-2 □□ M	FT4700 FT6500 FT7000-0-03 □□ M FT7000-0-3 □□ M
4.0	5220PF00404	
4.8	5220PF00484	
5.6	5220PF00564	5220PF00564
6.4		5220PF00644

8. FT7000 壓腳與相關零件 Presser Foot Components For Ft7000

序號	物料編號	名稱	單位用量
Ref. No.	Parts Number	Description	Amt. Req.
1	2280000801	壓力調整螺椿 Spring Regulator -----	1
2	8MB05320509G	螺絲 Screw (CT0802 M5-0.8*5) -----	2
3	2220000803	螺帽 Nut -----	1
4	2210000804	彈簧 Spring -----	1
5	2200000805	壓腳棒連結臂 Presser Bar Clamp -----	1
6	8MC95300808E	螺絲 Screw (CT1038 M4.5-0.75*8) -----	1
7	2200000807	滑道 GuideBlock (CT0807)-----	1
8	8MC95301608E	螺絲 Screw (C08-08 M4.5-0.75*16) -----	2
9	2210000809	彈簧 Spring -----	1
10	2200000810	壓腳棒 Presser Bar (CT0810) -----	1
11	2200000811	阻油片 Oil Separator -----	1
12	2220000812	限動環 Stop Collar -----	1
13	2220000813	固定切刀 Knife -----	1
14	8MH85240300A	螺絲 Screw (CT0813 M3.5-0.6*3) -----	2
15	-----	壓腳 Presser Foot(See Left Page) -----	1
15-A	5220PF0356M	螺絲 Screw (M3.5-0.6*8) -----	1
15-B	5221PF0956C	螺絲 Screw(1/8"-44*11) -----	1
15-C	5220PF0356D	螺帽 Nut -----	1
15-D	8SB24560405A	螺絲 Screw (SH0413 3/32"-56*4) -----	1
15-E	5220PF0056L	導布定規 Curl Guard -----	1
16	2200000816	彈簧 Spring (CT0816) -----	1
17	2200000817	連桿 Link (CT0817) -----	1
18	2220000818	護指擋片 Safety Plate Holder ) -----	1
19	2200000819	連桿 Lever (CT0819) -----	1
20	90SP0416	彈簧銷 Spring Pin(CT0820) -----	1
21	2200000821	彈簧 Spring (CT0821) -----	1
22	2200000822	定位環 Collar (CT0822) -----	2
23	8MC95300606F	螺絲 Screw (CT0823 M4.5-0.75*5.5) -----	4
24	2200000824	軸 Shaft (CT0824) -----	1
25	220A0000825	定位環組 Collar Asm.(CT0822A) -----	2
26	2200000826	連桿 Lever (CT0826) -----	1
27	8MM05321409A	螺絲 Screw (CT0632 M5-0.8*14) -----	1
28	90ER030	E形扣環 E Ring (CT0828) -----	2
29	2200000829	連結銷 Connecting Pin (CT0829) -----	2
30	2200000830	連桿 Link (CT0830) -----	1
31	2200000831	連桿 Lever (CT0831) -----	1
32	8MC06401008E	螺絲 Screw (C0832 M6-1*9.5) -----	1
33	2210000833	揚昇臂 Lifter Arm -----	1
34	2210000834	揚昇臂限位片 Stopper -----	1
35	8MB85240607K	螺絲 Screw (C0637 M3.5-0.6*6) -----	3
36	2200000836	曲柄 Drive Arm (CT0836) -----	1
37	8MK95301407A	螺絲 Screw (C0837 M4.5-0.75*14) -----	1
38	2200000838	曲軸 Shift (CT0838) -----	1
39	222A0000842	限動環組 Stop Collar Asm -----	1
40	220A0000840	連桿組 Link Asm.(CT0826A) -----	1
41	8MB03200405A	螺絲 Screw (FT0548 M3-0.5*4) -----	1