

1. 66708 線架 Thread Stand 66708

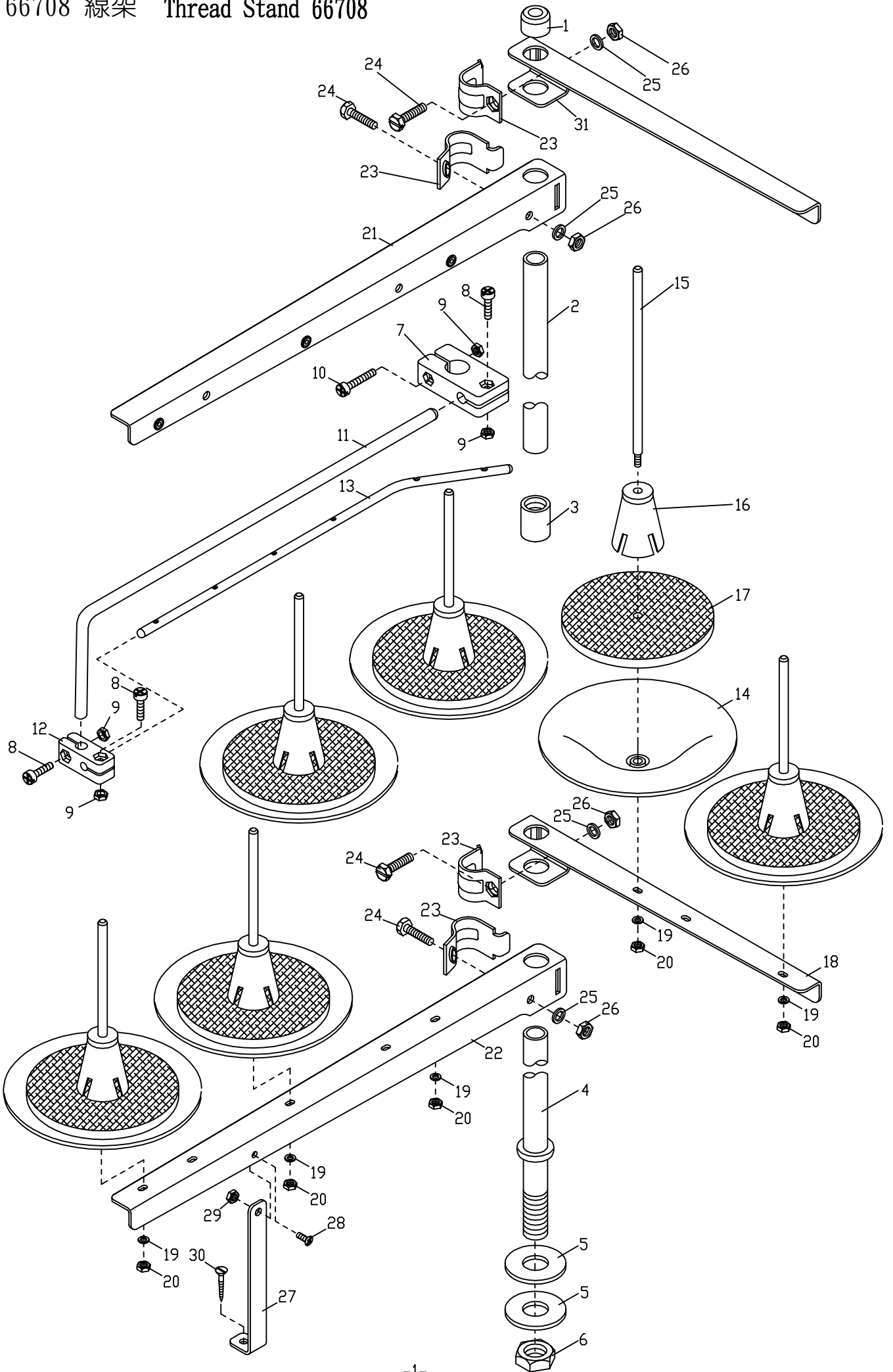

1. 66708 線架 Thread Stand 66708

| 序號 Ref. No. | 物料編號 Parts No. | 名稱 Description | 單位用量 Amt. Req. |
|----------------|-------------------|---------------------------------|-------------------|
| 1 | 667051 | 柱帽 Rod Cover ----- | 1 |
| 2 | 667052 | 上柱 Upper Thread Stand Rod ----- | 1 |
| 3 | 667053 | 接頭 Joint ----- | 1 |
| 4 | 667054 | 下柱 Lower Thread Stand Rod ----- | 1 |
| 5 | 667055 | 墊圈 Washer ----- | 2 |
| 6 | 667056 | 螺帽 Nut ----- | 1 |
| 7 | 667057 | 接頭 Bracket ----- | 1 |
| 8 | 667058 | 螺絲 Screw ----- | 3 |
| 9 | 667059 | 螺帽 Nut ----- | 4 |
| 10 | 6670510 | 螺絲 Screw ----- | 1 |
| 11 | 6670511 | 旋臂 Arm ----- | 1 |
| 12 | 6670512 | 接頭 Bracket ----- | 1 |
| 13 | 6670513 | 導線桿 Thread Guide ----- | 1 |
| 14 | 6670514 | 線盤 Spool Set for SH6005 ----- | 6 |
| 15 | 6670515 | 線盤軸 Spool Pin ----- | 6 |
| 16 | 6670516 | 定心錐 Spool Retaining Lup ----- | 6 |
| 17 | 6670517 | 緩衝墊 Seat ----- | 6 |
| 18 | 6670522 | 線盤座 Spool Set Bracket ----- | 1 |
| 19 | 6670519 | 彈簧墊圈 Spring Washer ----- | 5 |
| 20 | 6670520 | 螺帽 Nut ----- | 5 |
| 21 | 6670521 | 導線臂 Thread Guide ----- | 1 |
| 22 | 6670522 | 線盤座 Spool Set Bracket ----- | 1 |
| 23 | 6670523 | 夾板 Clamp ----- | 4 |
| 24 | 6670524 | 螺絲 Screw ----- | 4 |
| 25 | 6670525 | 彈簧墊圈 Spring Washer ----- | 4 |
| 26 | 6670526 | 螺帽 Nut ----- | 4 |
| 27 | 6670527 | 撐桿 Support Rod ----- | 1 |
| 28 | 6670528 | 螺絲 Screw ----- | 1 |
| 29 | 6670529 | 螺帽 Nut ----- | 1 |
| 30 | 6670530 | 木螺絲 Wood Screw ----- | 1 |
| 31 | 6670521 | 導線臂 Thread Guide ----- | 1 |